

ONLY FITTINGS ALLOWED BETWEEN FIRST OS&Y VALVE AND BACKFLOW ASSEMBLY TO BE 90° BEND

NO PRESSURE GAUGES OR PRESSURE GAUGE FITTINGS WILL BE ALLOWED ON THE TEST PORTS OF ANY BACKFLOW ASSEMBLY

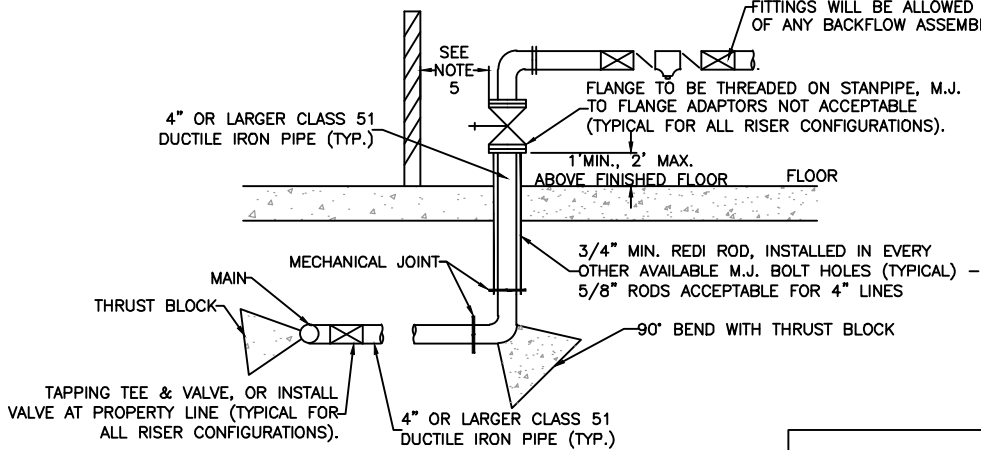

LEGEND

	FLANGED OS&Y VALVE
	REDUCED-PRESSURE BACKFLOW-PREVENTION ASSEMBLY (MINIMUM REQUIREMENT) AS INDICATED ON APPROVED PLAN(S)

- BIG SKY COUNTY WATER & SEWER DISTRICT 363 REQUIREMENTS FOR INSTALLATION OF REDUCED PRESSURE BACKFLOW PREVENTION ASSEMBLY
- The FIRST fitting inside of the building shall be a UL listed flanged Kennedy or Mueller OS&Y valve the same size as the fire service line.
 - All Double Check Valve Assemblies shall be:
 - UL or FM listed
 - Approved by the University of Southern California Foundation for Cross Connection Control and Hydraulic Research (USCFCCCHR) for operation in the proposed position (vertical or horizontal) as shown on approved plans.
 - Installed as shown on the approved plans
 - A flow detection device shall be installed immediately following the Double Check Valve Assembly (alarm check valve, flow sensor/alarm, meter, etc.) as shown on the approved plans. Paddle-type flow alarms not permitted on dry systems.
 - Horizontal installations must be a minimum of 2' above the finished floor.
 - The fire service riser must be a minimum of 2' from any outside wall, and a minimum of 1' from any interior wall.
 - The incoming fire service line shall be a minimum of 6.5', and a maximum of 8.0' below the finished grade.
 - All fire service line appurtenances shall have a minimum pressure rating of 200 PSI.
 - All fire service lines 4" and larger shall be Class 51 Ductile Iron Pipe.
 - Line sizing: The Double Check Valve Assembly shall be equal in size to both the incoming pipe diameter (upstream) and outgoing pipe diameter (downstream). For example, a 4" fire service line shall have a 4" Double Check Valve Assembly.
 - A drain is required

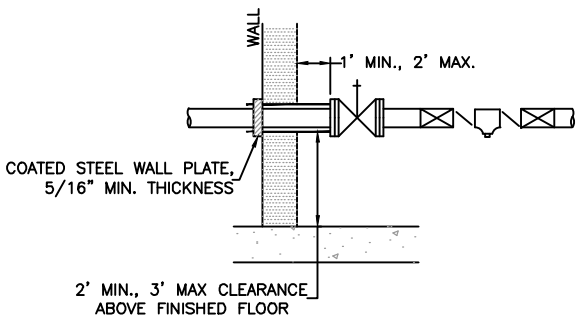
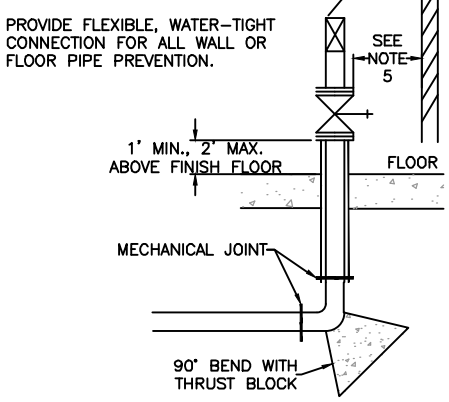

DETAIL NO.: BSWSD: 26-14	BIG SKY WSD 363 STANDARD DRAWING	SCALE: NONE	STANDARD FIRE SERVICE LINE INSTALLATION	DATE: FEBRUARY 2010
				LAST REVISION: MARCH 2016
				CROSS REFERENCE WITH: SIMILAR TO: COB: 02660-14